

# Riddle Hospital's Modernization Project: Building for Our Future

Riddle Hospital's Campus Master Plan will mark the most significant facility improvement in its existence and among the largest capital investments in Main Line Health history. The modernization project will include a new patient pavilion, as well as renovations to existing care units and support areas and will also include new parking. Once completed in 2024, the hospital will be equipped with all private patient rooms, contemporary facilities and advanced technology to support the evolving needs of the community.



## Getting here

Riddle Hospital is located at:  
**1068 West Baltimore Pike**  
**Media, PA 19063**  
**484.227.9400**

### From Center City Philadelphia (Northeast)

1. Take Interstate 95 South to PA 476 North.
2. Take Exit 5 (Springfield/Lima).
3. Continue on US Route 1 South (Media Bypass) toward Lima, approximately 4 miles.
4. Bypass merges onto Business Route 1 South (Baltimore Pike).
5. Pass under Route 352 (Middletown) overpass.
6. Stay in the left hand lane, turn left at the 2nd traffic light (West Entrance).
7. Follow signs for your destination.

### From City Line Avenue (North)

1. Take City Line Avenue, US Route 1 South (approx. 15 miles).
2. Route 1 will become Media Bypass as you cross under overpass, juncture with Route 320.
3. Continue on US Route 1 South (Media Bypass) toward Lima, approximately 4 miles.
4. Bypass merges onto Business US Route 1 South (Baltimore Pike).
5. Pass under Route 352 (Middletown) overpass, Stay in the left hand lane, turn left at the 2nd traffic light (West Entrance).
6. Follow signs for your destination.

### From Route 202 and Route 1 (West)

1. Take US Route 1 North (Baltimore Pike ) approx. 8 miles.
2. After intersection with Route 452 (Pennell Road) stay in right hand lane for approximately 0.5 miles. Turn right at second traffic light (West Entrance).
3. Follow signs for your destination.

### From Scranton and Allentown (North)

1. Take PA Turnpike (Northeast Extension) 476 South to Mid County Interchange.
2. After toll booths continue South on Route 476 (Blue Route), take Exit 5 (Springfield/Lima) US Route 1 South (Media Bypass) toward Lima approximately 4 miles.
3. Bypass merges onto Business US Route 1 South (Baltimore Pike).
4. Pass under Route 352 (Middletown) overpass.
5. Stay in the left hand lane, turn left at the 2nd traffic light (West Entrance).
6. Follow signs for your destination.

### From Wilmington, Delaware (South East)

1. I-95 North to Exit 2 (Boothwyn), Route 452.
2. Take Route 452 North approx. 5.7 miles to US Route 1 North.
3. After approximately 0.5 miles, stay in right hand lane, turn right at the traffic light.
4. Follow signs for your destination.

### Parking

During construction, valet parking will be available at several entrances for five dollars. Self-service garage parking in the South and West Parking Garages will have a flat fee. In addition there is surface parking in the rear of the hospital for outpatient services.

### Other Information

#### Security

484.227.8429

#### Cafeteria

Sunday-Saturday: 7:00 am-7:00 pm

#### Gift Shop

Monday-Friday: 9:00 am-7:00 pm

Saturday: 11:00 am-3:00 pm

Sunday: Closed

[mainlinehealth.org/rhmodernization](http://mainlinehealth.org/rhmodernization)



**Main Line Health®**  
**Riddle Hospital**

West Entrance

W. Baltimore Pike

East Entrance

Health Center 4

West Garage

Main Hospital

Health Center 1

Health Center 2

Health Center 3 (Outpatient Pavilion)

South Garage

Closed during construction

Interior Map  
Main Circulation  
Level 1

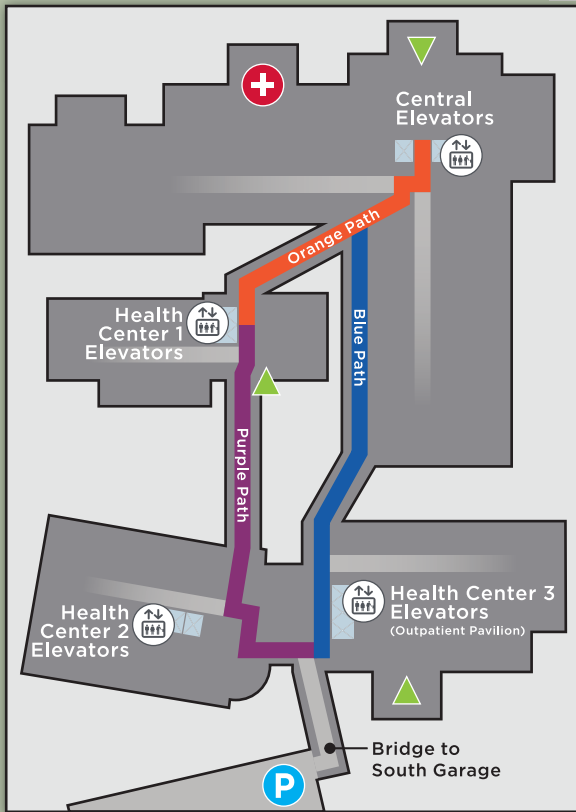

P1-2/27/20

Exterior Map  
[Phase 1]

- Bus
- EMERGENCY
- Parking
- Campus Entrance
- Emergency Entrance
- Valet
- Construction Area
- Entrance
- Route to Main Entrance
- Elevators
- Garage Entrance

